

CNC TABLE & BT30 TOOLING for FANUC ROBODRILL

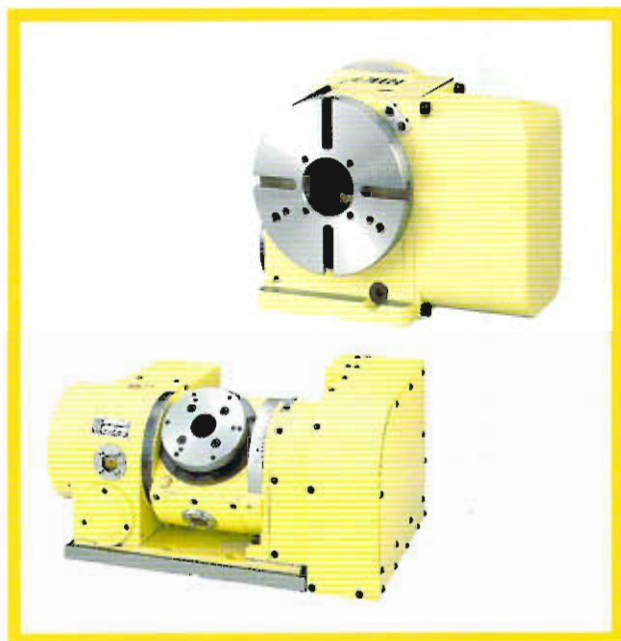

ДЖАПАН ТУЛ СЕРВИС,ЛТД
представительство в москве

Россия, 119049 Москва
Коровий вал д7, под 6. кв 168
Тел./факс : (495) 970-15-73
<http://www.jtools.biz>
e-mail : info@jtools.biz
<http://www.japantool.ru>



JAPAN TOOL SERVICE

NIKKEN KOSAKUSHO WORKS, LTD.

SOC0709F



NIKKEN

MADE IN JAPAN MADE BY NIKKEN



OSAKA DAITO FACTORY
LAND:55,000㎡ BUILDING:25,000㎡

NIKKEN KOSAKUSHO WORKS, LTD

NIKKEN is a manufacturer of Tool Holders, CNC Rotary Tables and Reamers, we have been market leaders in various industries, i.e. Aerospace, Automotive, and Ultra Precision Machining ever since the company was created in 1958.

We are proud that our 'Total Manufacturing System' enormously contributes to all of the above mentioned industries from raw material to precision finish machining.

For more information, please contact us

export@nikken-kosakusho.co.jp

<http://www.nikken-kosakusho.co.jp>

<http://www.nikken-world.com>



CNC ROTARY TABLES

NIKKEN ROTARY TABLE

- Ion Nitrided Worm Wheel
HV 930



- Manufactured from Superior Materials
- High accuracy
- Greater wear resistance over long term
- Maintenance Free

CONVENTIONAL ROTARY TABLES

OTHERS

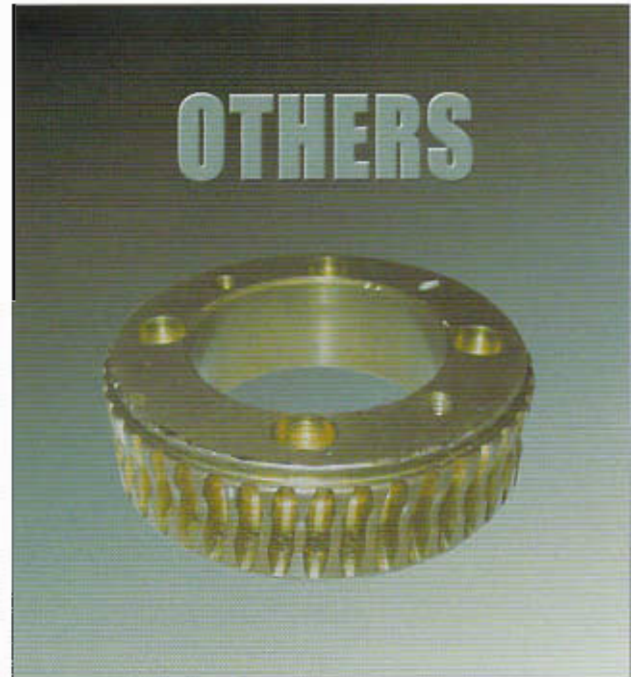

- Manufactured from Soft Material,
Phosphor Bronze / Aluminium Bronze
- Poor wear resistance
- Periodical compensation for
Backlash is required

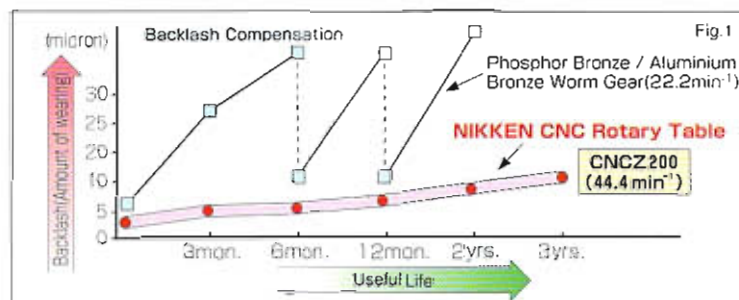
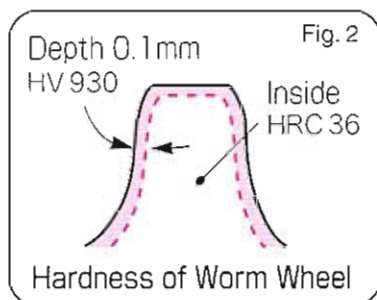

CNC ROTARY TABLES

ADDITIONAL 4TH AXIS SPECIFICATION

CNCZ 105 L FA

■SERIES OF 4TH AXIS ■TABLE DIA ■MOTOR POSITION ■FANUC SPEC
 ■CNC HIGH SPEED TYPE
 ■CNC STANDARD



CNCZ105L

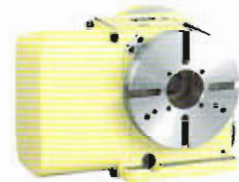

CNC180L

ITEM/CODE NO.	CNCZ105LFA	CNC180LFA
SERVO MOTOR	α1/5000i A06B-0202-B000	α2/5000i A06B-0205-B000
DIAMETER OF TABLE φ mm	105	180
DIAMETER OF SPINDLE HOLE φ mm	60H7 x 30	60H7 x 40
CENTER HEIGHT mm	105	135
CLAMPING SYSTEM	PNEUMATIC	PNEUMATIC
CLAMPING TORQUE 0.5MPa N·m	205	303
TOTAL REDUCTION RATIO	1/45	1/90
MAX ROTATION SPEED MOTOR 2000min ⁻¹ min ⁻¹	44.4	22.2
INDEXING ACCURACY sec	±30	±20
NET WEIGHT kg	30	43
MAX. WORK INERTIA kgm ²	0.04	0.4

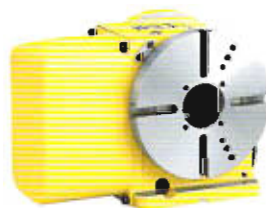

CNC202L

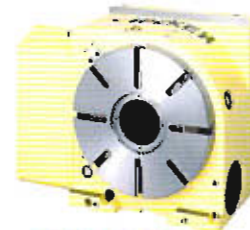

CNC260L

ITEM/CODE NO.	CNC202LFA	CNC260LFA
SERVO MOTOR	α4/4000i A06B-0223-B000	α4/4000i A06B-0223-B000
DIAMETER OF TABLE φ mm	200	260
DIAMETER OF SPINDLE HOLE φ mm	60H7 x 40	80H7
CENTER HEIGHT mm	135	170
CLAMPING SYSTEM	PNEUMATIC	PNEUMATIC
CLAMPING TORQUE 0.5MPa N·m	303	343
TOTAL REDUCTION RATIO	1/90	1/120
MAX ROTATION SPEED MOTOR 2000min ⁻¹ min ⁻¹	22.2	16.6
INDEXING ACCURACY sec	±20	20
NET WEIGHT kg	49	120
MAX. WORK INERTIA kgm ²	1	3.2



PLEASE REFER CNC ROTARY TABLE SERIES CATALOGUE FOR MORE INFO.

CNC ROTARY TABLES

ADDITIONAL 4TH& 5TH AXIS SPECIFICATION

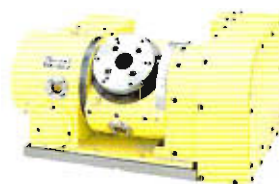

5AX-130

5AX - 130

FA

■SERIES OF 4TH AXIS

■TABLE DIA.

■FANUC SPEC

ITEM/CODE NO.	5AX-130FA	
AXIS	ROTARY	TILTING
SERVO MOTOR	$\alpha 2/5000i$ A06B-0205-B000	$\alpha 2/5000i$ A06B-0205-B000
DIAMETER OF TABLE ϕ mm	105(supplied WITH $\phi 130$ plate)	
DIAMETER OF SPINDLE HOLE ϕ mm	60H7 x 30	
CENTER HEIGHT mm	150 at 90°	
CLAMPING SYSTEM	PNEUMATIC	PNEUMATIC
CLAMPING TORQUE 0.5MPa / 35MPa N·m	205	303
TOTAL REDUCTION RATIO	1/90	1/180
MAX ROTATION SPEED MOTOR 2000min min^{-1}	22.2	11.1
INDEXING ACCURACY sec	± 30	60
NET WEIGHT kg	99.5	
MAX WORK INERTIA kgm^2	0.12	

OPTIONAL ACCESSORIES

TABLE MODEL	CENTER HEIGHT				
		TAIL STOCK MANUAL	TAIL STOCK PNEUMATIC / HYDRAULIC	SUPPORT TABLE WITH BRAKE	SUPPORT TABLE W/O BRAKE
CNC105	105	P-105S	PBA-105	TAT105	CST100-105
CNC180	135	P-125S	PBA-135	TAT170	CST100-135
CNC202	135	P-125S	PBA-135	TAT170	CST100-135
CNC260	170	P-170S	PBA-170	TAT250	
5AX-130	150	P-150S	PBA-150		

WE HAVE MORE OPTIONS SUCH AS **SCROLL CHUCK, POWER CHUCK, AND 5C COLLET CHUCK** ETC.

PLEASE REFER "CNC ROTARY TABLE SERIES" CATALOGUE FOR MORE INFO.



LAYOUT for α -T14iEs(e) α -T21iEs(e)



CNC180L

CNC202L





LAYOUT for α -T14iE(e) α -T21iE(e)

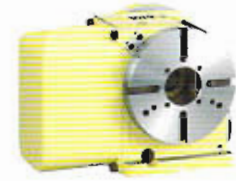
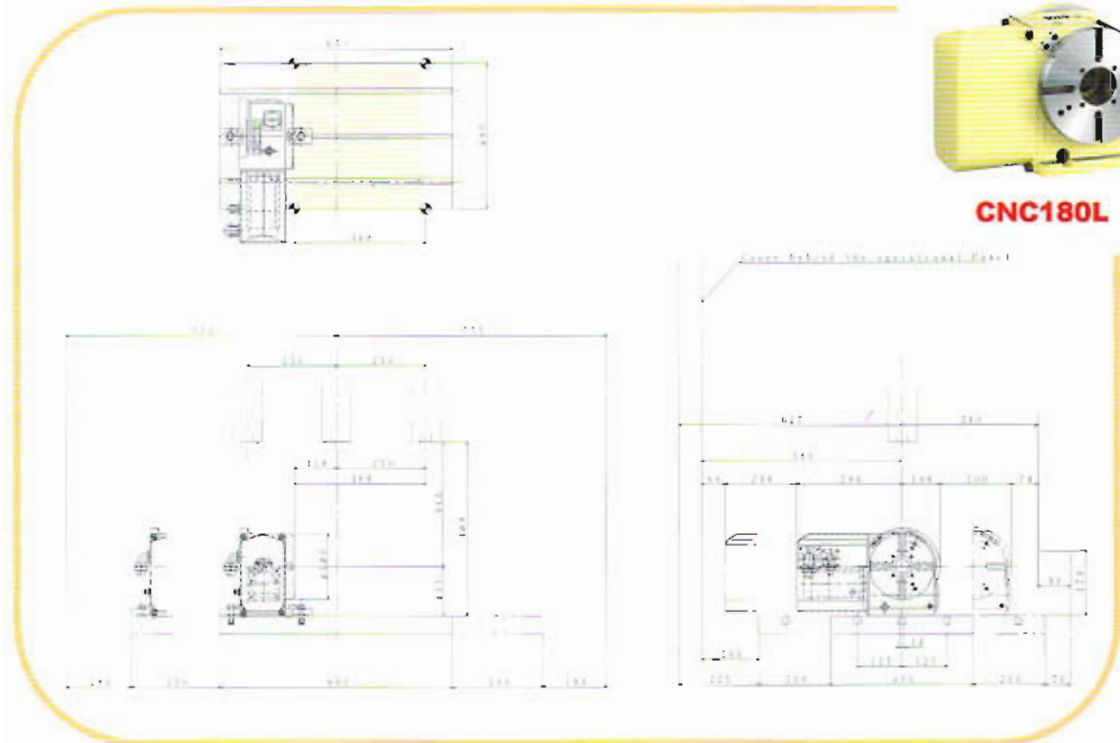

CNC180L

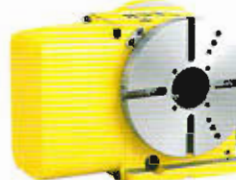
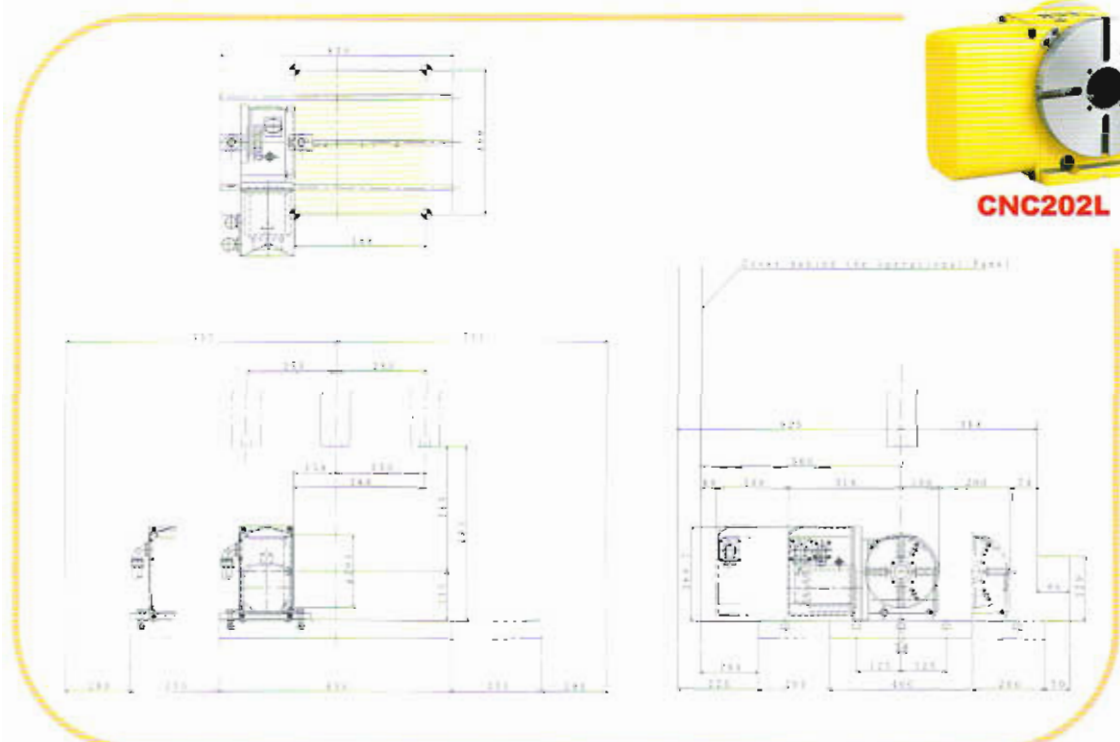

CNC202L



LAYOUT for α -T14iE(e) α -T21iE(e)

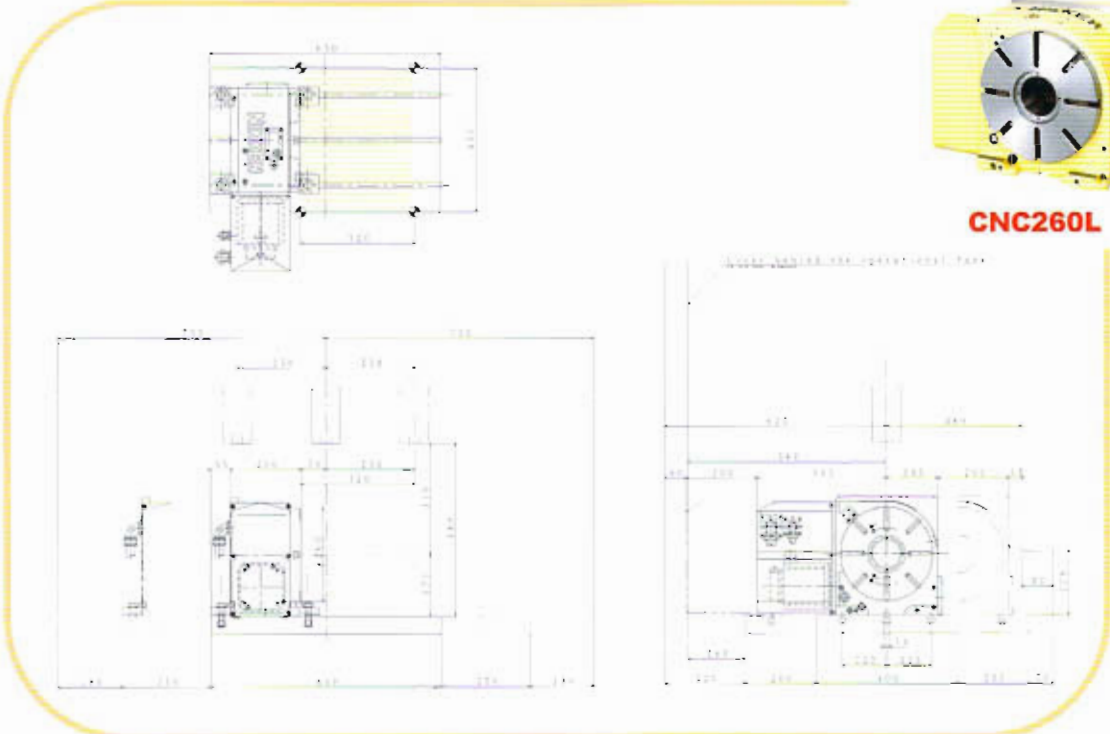

CNC260L

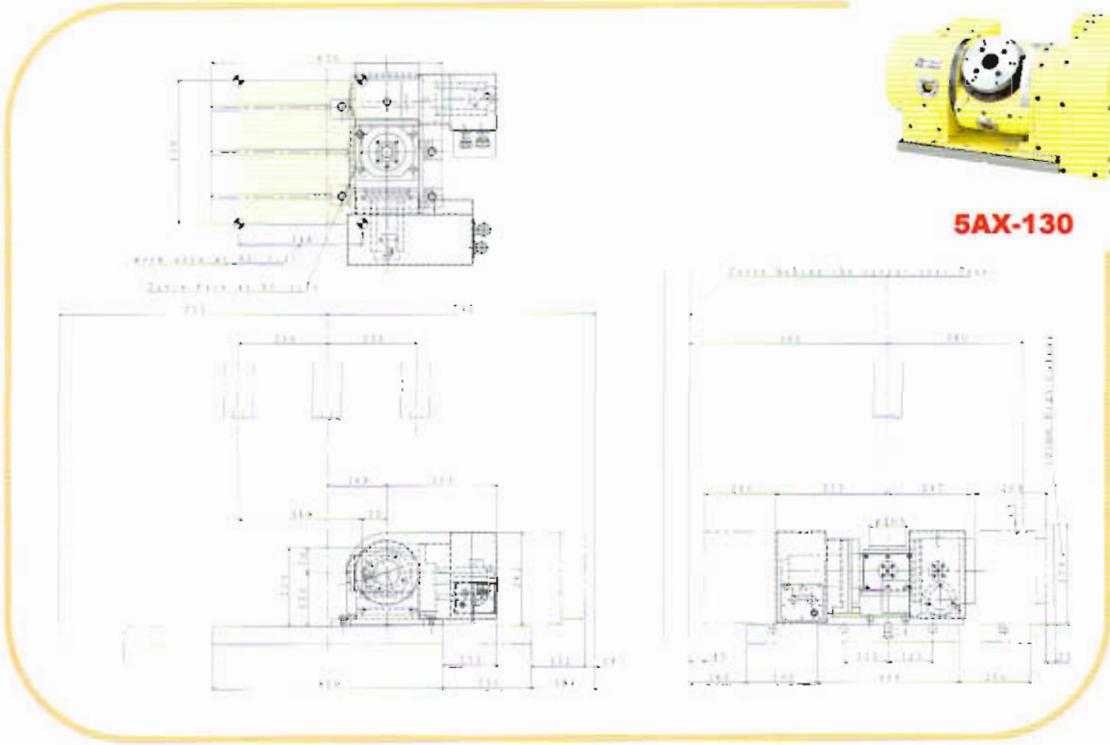

5AX-130





LAYOUT for α -T14iEL(e) α -T21iEL(e)

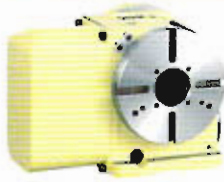

CNC180L

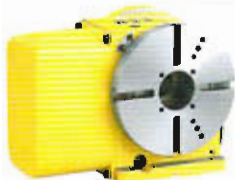
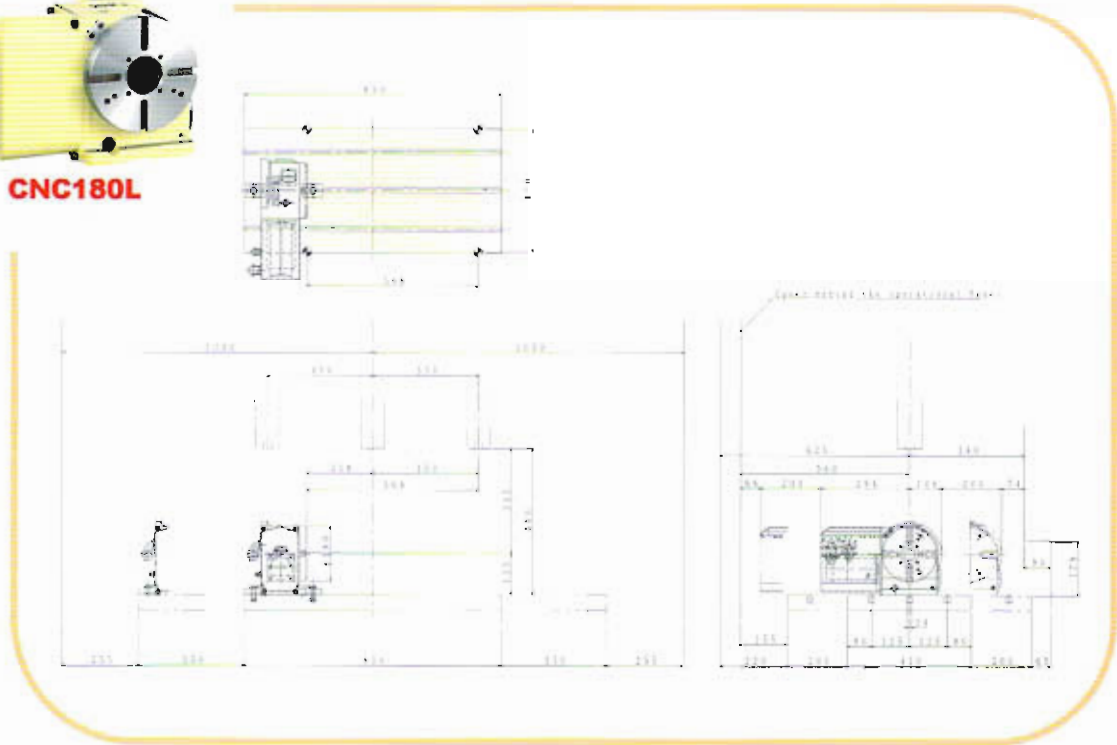

CNC202L

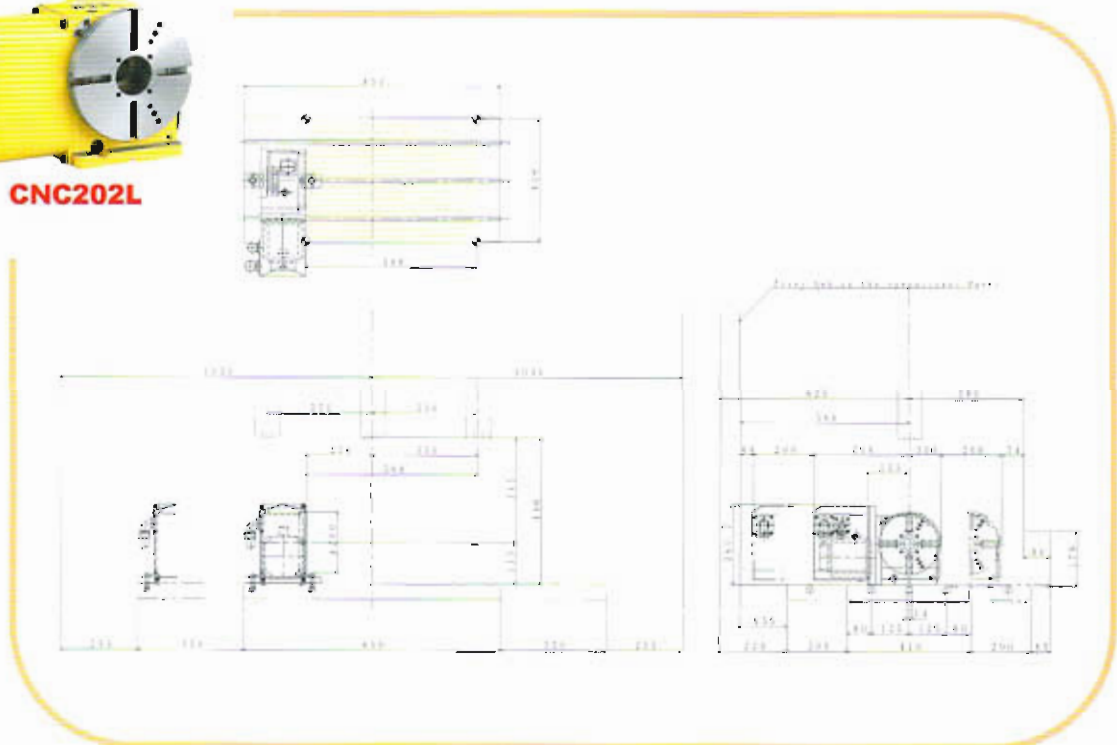

LAYOUT for α -T14iEL(e) α -T21iEL(e)

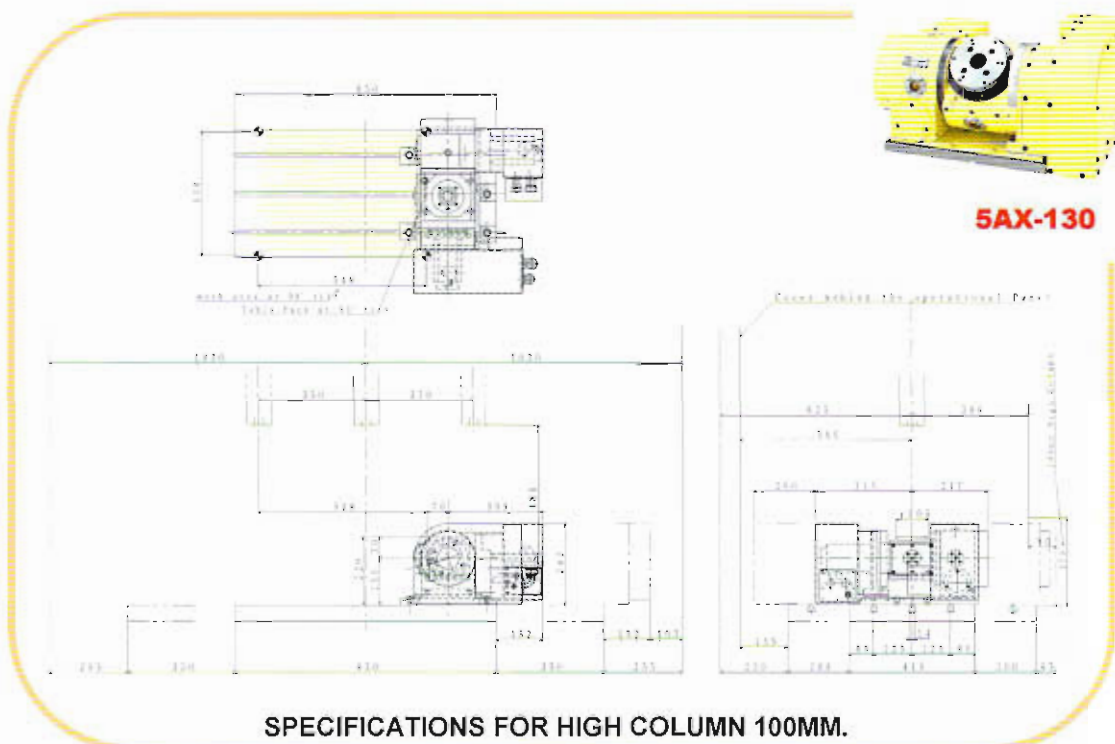
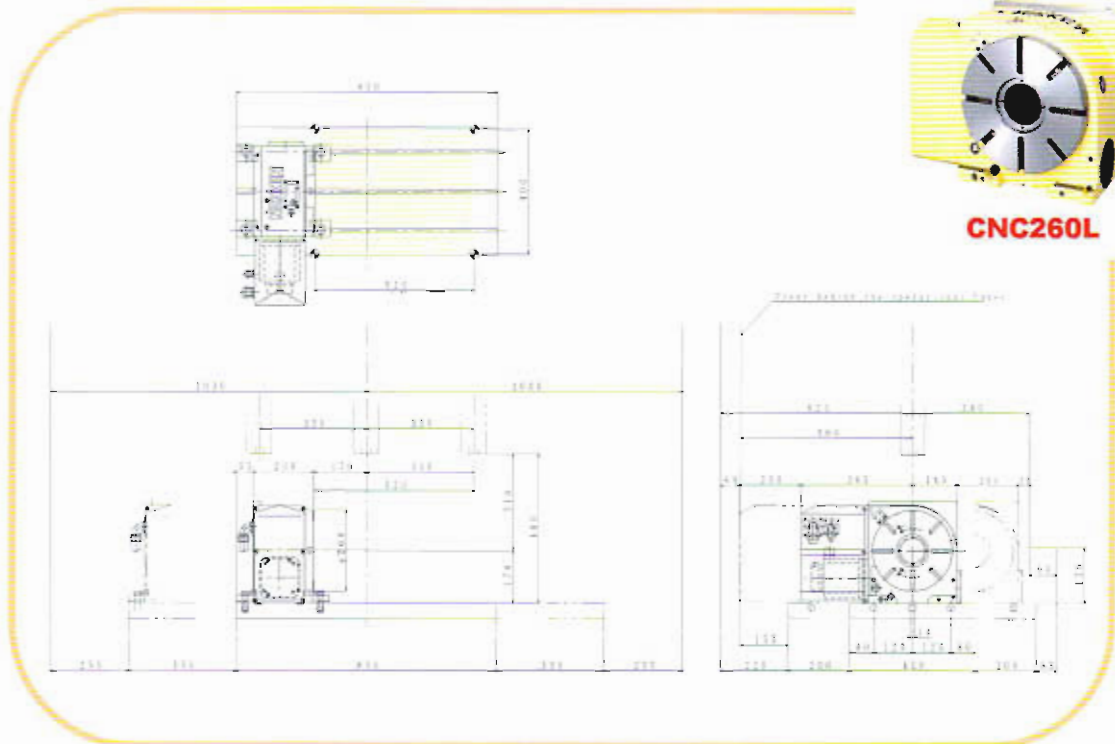

SPECIFICATIONS FOR HIGH COLUMN 100MM.



BT30 TOOLING SYSTEM

MULTI-LOCK MILLING CHUCK



- Multi roller bearing system (140% more roller bearings than others) Powerful gripping torque & durability without damage on surface.

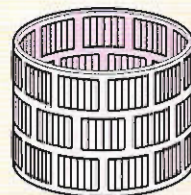

NIKKEN
MULTI-ROLLER
system

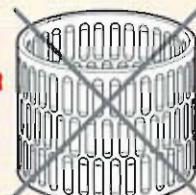

Imitation
roller system

- Thick wall and internal slots.

	When oil is removed completely with blinner	When a little oil is adhered	%
NIKKEN With Slots	5,000Nm	4,800Nm	Only 5% Down
OTHERS Without Slots	3,500Nm	1,250Nm	67% Down

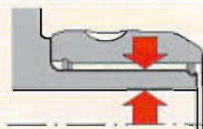

Thick wall and slots provides strong chucking torque and rigidity. Further, slots functions as escape of oil.

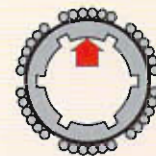

- New Clamping at Root & Anti-Vibration Mechanism

JAPAN, USA, FRANCE, ITALY, SPAIN, KOREA, TAIWAN PAT.
GERMANY PAT.P

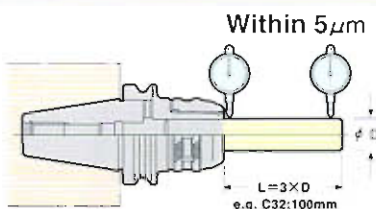

- Fine Run-Out Accuracy



BT30 TOOLING SYSTEM

STANDARD MILLING CHUCK





CODE NO.	※ MAX. SPEED	COLLET 	WRENCH 
BT30-C20-75	6,000	KM20	9HC22
BT30-C25-75	5,000	KM25	9HC25
BT30-C32-100	3,000	KM32	9HC32

※MAX.SPEED shows the guide line of the maximum speed.

HIGH SPEED MILLING CHUCK



CODE NO.	MAX. SPEED	COLLET 	WRENCH 
BT30-C20-75 G	30,000	KM20	GH16
BT30-C25-75 G	25,000	KM25	GH25
BT30-C32-100 G	10,000	KM32	GH32

The following variation is also available.

NBT30
NC5-46

2LOCK DOUBLE FACE CONTACT
NC5 DOUBLE FACE CONTACT

KM COLLET

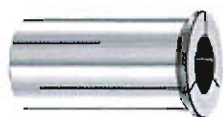

CODE NO.	INTERNAL DIAMETER
KM20	- 2/3/4/5/6/7/8/9/10/11/12/13/14/15/16
KM25	- 3/4/5/6/7/8/9/10/11/12/13/14/15/16/17/18/19/20/21/22
KM32	- 3/4/5/6/7/8/9/10/11/12/13/14/15/16/17/18/19/20/21/22/23/24/25/26

PLEASE REFER "NC TOTAL TOOLING SYSTEM" CATALOGUE FOR MORE INFO.



BT30 TOOLING SYSTEM

SLIM CHUCK **TiN BEARING BUILT IN**



Power of TiN Bearing (HV2,200)



Surface Contact



Point Contact

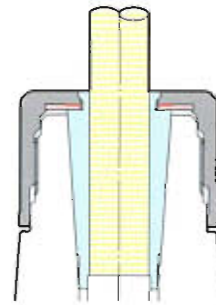

NIKKEN

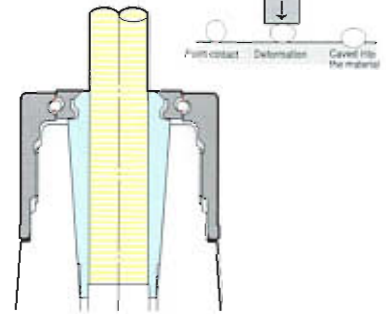

OTHERS

- High run-out accuracy due to TiN BEARING
- High gripping torque of 8 deg. taper
- Standard collet can be used for high pressure coolant system.

- Unstable run-out accuracy due to taper part pushing
- Poor gripping torque of 12 deg. or 16 deg. taper
- Complicated Nut Balance will be changed at high speed rotation because of ball bearing inside.

- Uses 8° Taper and Wedge Principle
- Grip Torque double that of 16° type

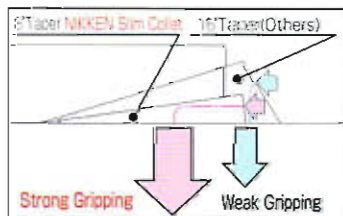

NIKKEN

FLAT SHOULDER PUSHING

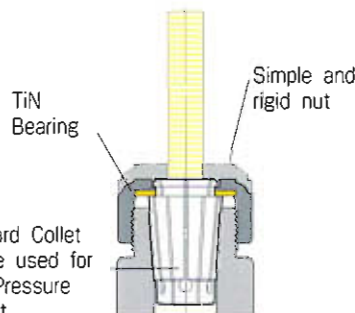

Standard Collet can be used for High Pressure Coolant

OTHERS

TAPER PUSHING

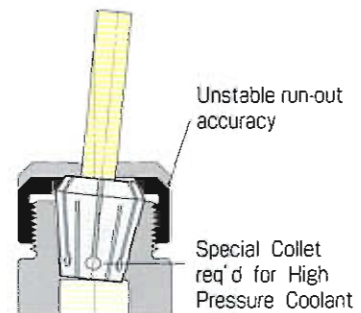



Special Collet req'd for High Pressure Coolant



BT30 TOOLING SYSTEM

STANDARD SLIM CHUCK





CODE NO.	※ MAX. SPEED	COLLET 	WRENCH 
BT30-SK6-60,90	15,000	SK6	SKL-6W
BT30-SK10-60,90	15,000	SK10	SKL-10
BT30-SK16-60,90	10,000	SK16	9HC16

※MAX.SPEED shows the guide line for the shortest gauge length tool.

HIGH SPEED SLIM CHUCK



CODE NO.	MAX. SPEED	COLLET 	WRENCH 
BT30-GSK6-60P,90P	40,000	SK6	GH6
BT30-GSK10-60P,90P	40,000	SK10	GH10
BT30-GSK16-60P,90P	30,000	SK16	GH16

The following variation is also available.

NBT30
NC5-46

2LOCK DOUBLE FACE CONTACT
NC5 DOUBLE FACE CONTACT

SK COLLET



CODE NO.	INTERNAL DIAMETER
SK6 -	2/3/4/5/6/7/8/9/10
SK10 -	2/3/4/5/6/7/8/9/10/11/12
SK16 -	2/3/4/5/6/7/8/9/10/11/12/13/14/15/16

PLEASE REFER "NC TOTAL TOOLING SYSTEM" CATALOGUE FOR MORE INFO.



BT30 TOOLING SYSTEM

MAJOR DREAM HOLDER



CODE	COLLET	WRENCH
BT30-MDSK10-60, 90	SK10	GH10
BT30-MDSK16-75, 90	SK16	GH16

Dampening Mechanism prevents 'micro-chipping' of the cutting edge at the initial stage – therefore no fretting corrosion occurs and excellent cutting is produced.

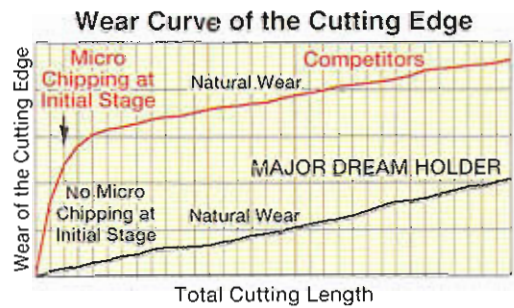

MAJOR DREAM BASE HOLDER & ZMAC BORING ARBOR



We have a strong **CONFIDENCE** in the ability of BT30 ZMAC BORING BAR, range $\phi 15.9 \sim 70.2$.

Please contact us for more details.



FACEMILL ARBOR



CODE
BT30-FMA25.4-45

TOOL CLAMPER



CODE
NCL-BT30

PULL STUD



CODE	REMARKS
PS-16	MAS-P30T- I
PS-132	WITH A HOLE



PLEASE REFER "NC TOTAL TOOLING SYSTEM" CATALOGUE FOR MORE INFO.

PACKAGE IDEAS

TOOLING PACKAGE FOR STANDARD SPEED

DESCRIPTION	CODE	FOR ATC 14	FOR ATC 21
MILLING CHUCK	BT30-C20-75	2	2
KM COLLET	KM20-6/8/10/12/16	each 1	each 2
MILLING CHUCK	BT30-C25-75	1	2
KM COLLET	KM25-6/8/10/12/16/20	each 1	each 1
FACEMILL ARBOR	BT30-FMA25.4-45	1	1
MAJOR DREAM HOLDER	BT30-MDSK10-60	2	2
SLIM CHUCK	BT30-SK10-90	2	5
	BT30-SK16-90	2	5
	BT30-SK6-60	2	2
	BT30-SK6-90	2	2
SK COLLET	SK6-2/4/5/6	each 2	each 2
	SK10-4/5/6/8/10	each 2	each 2
	SK16-6/8/10/12/16	each 1	each 2
WRENCH	9HC22, 9HC25	each 1	each 1
	GH10	1	1
	SKL-6W	1	1
	SKL-10	1	1
	9HC16	1	1
PULL STUD	PS-16 or PS-132	14	21

TOOLING PACKAGE FOR HIGH SPEED

DESCRIPTION	CODE	FOR ATC 14	FOR ATC 21
MILLING CHUCK	BT30-C20-75G	2	2
KM COLLET	KM20-6/8/10/12/16	each 1	each 2
MILLING CHUCK	BT30-C25-75G	1	2
KM COLLET	KM25-6/8/10/12/16/20	each 1	each 2
FACEMILL ARBOR	BT30-FMA25.4-45	1	1
MAJOR DREAM HOLDER	BT30-MDSK10-60P	2	2
SLIM CHUCK	BT30-GSK10-90P	2	5
	BT30-GSK16-90P	2	5
	BT30-GSK6-60P	2	2
	BT30-GSK6-90P	2	2
	BT30-GSK6-90P	2	2
SK COLLET	SK6-2/4/5/6	each 2	each 2
	SK10-4/5/6/8/10	each 2	each 2
	SK16-6/8/10/12/16	each 1	each 2
TOOL CLAMPER	NCL-BT30	1	1
WRENCH	GH6	1	2
	GH10	1	2
	GH16	1	2
	GH20	1	2
	GH25	1	2
PULL STUD	PS-16 or PS-132	14	21

PLEASE REFER "NC TOTAL TOOLING SYSTEM" CATALOGUE FOR MORE INFO.



NIKKEN

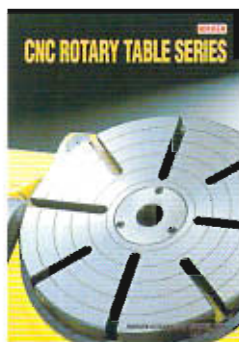
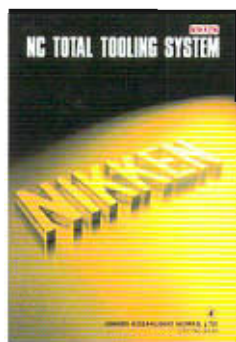

PLEASE GIVE YOUR ORDER TO THE FOLLOWING AGENT.

Please request "NC TOTAL TOOLING SYSTEM" and "CNC ROTARY TABLE SERIES" catalogue for more info.

NIKKEN KOSAKUSHO WORKS, LTD.

5-1, 1-chome, Minamishinden, Daito-shi, Osaka-fu, Japan TEL.: +81 (0)72 869 5820 FAX : +81 (0)72 869 5860